

VPLDSMAR – DRUVA®PUR SHUT-OFF VALVE

VALVE | PURE LINE (BRASS CHROME PLATED) | 20 m³ SERIES | DIAPHRAGM SHUT-OFF VALVE
| MANUAL ACTUATION | 2-PORT VERSION



2-port metal diaphragm shut-off valve is used in supply systems for pure, inert, flammable, oxidizing gases and gas mixtures. Not usable for corrosive and toxic gases and gas mixtures. Maximum gas purity is 6.0.



SPECIAL FEATURES:

- > Elgiloy diaphragm tightening system to atmosphere
- > Compact design
- > Designed and approved in accordance with relevant sections of ISO 10297:2015
- > O₂ ignition test according ISO 10297 for main shut off valves
- > Electrostatic chargeability test
 - Fulfills requirements according to ISO 80079-36; IEC TS 60079-32-1 and German TRGS 727
 - Usable in EX- areas zones 1 and 2 for gases with explosion risk group I; IIA; IIB; IIC

TECHNICAL DATA	
Working temperature:	-20 °C to +60 °C
Inlet / outlet ports:	1/4" NPT female Further connections – see technical drawing
Max. working pressure:	300 bar
Cv-value:	0,25
Seat diameter:	5 mm
Leakage rate seat:	<5x10 ⁻⁶ mbar l/s (Helium)
Leakage rate outside:	<1x10 ⁻⁹ mbar l/s (Helium)
Filter	1x for each inlet 1x for each outlet
Weight:	0,33 kg
Material gas wettet parts:	
Valve body:	Brass chrome plated
Valve diaphragm:	2x Elgiloy
Valve seat:	PCTFE
Valve poppet:	Brass
Test in production:	Pressure test with Helium of each item
	Seat leakage test with Helium of each item
	Helium leak test of each valve against atmosphere
	Test of functionality of each item
Approvals during development:	Type test in accordance with ISO 10297:2015
	O ₂ ignition test according ISO 10297 for main shut off valves
	Electrostatic chargeability test
	<ul style="list-style-type: none"> • Fulfill requirements according ISO 80079-36, IEC TS 60079-32-1 and German TRGS 727 • Usable in EX-areas zones 1 and 2 for gases with explosion risk group I, IIA, IIB, IIC

TECHNICAL DRAWING

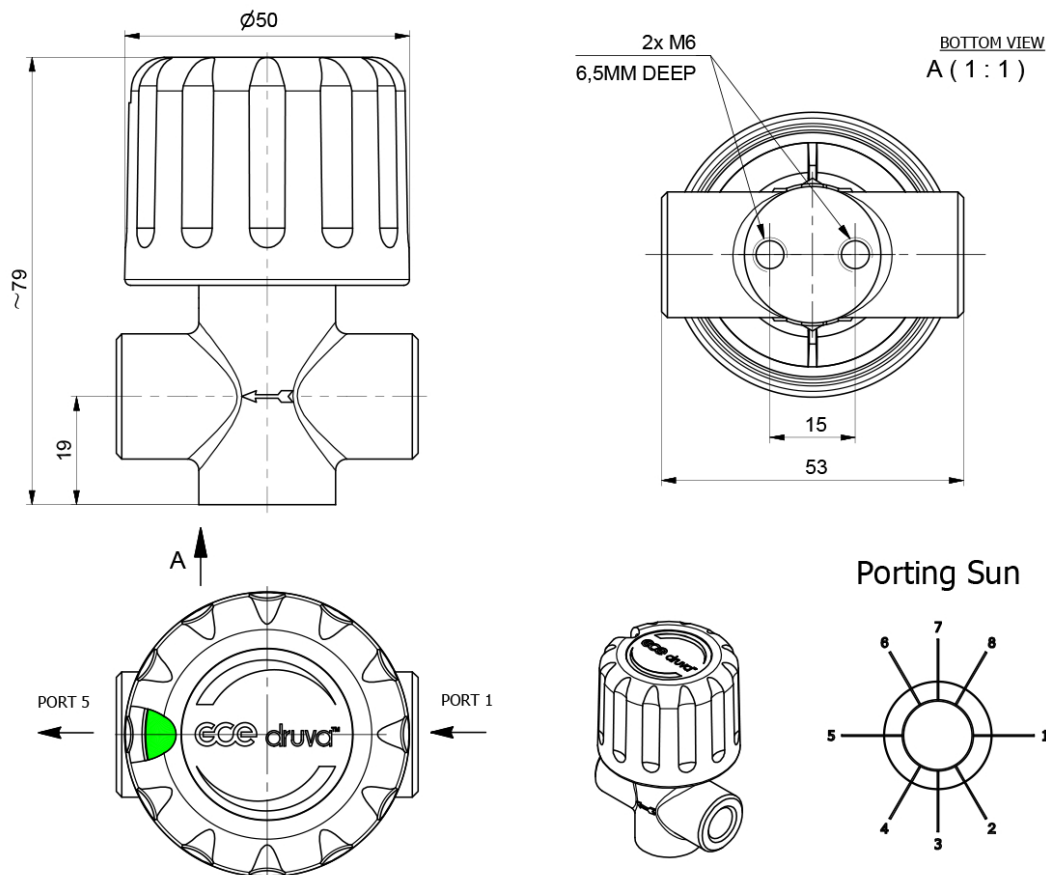

N14F - NPT1/4" female
 0000 - Without (Port 3 and Port 7)
 M03B - Compression Fitting \varnothing 3MM Brass
 M06B - Compression Fitting \varnothing 6MM Brass
 M08B - Compression Fitting \varnothing 8MM Brass
 M10B - Compression Fitting \varnothing 10MM Brass
 M12B - Compression Fitting \varnothing 12MM Brass

M03S - Compression Fitting \varnothing 3MM SST
 M06S - Compression Fitting \varnothing 6MM SST
 M08S - Compression Fitting \varnothing 8MM SST
 M10S - Compression Fitting \varnothing 10MM SST
 M12S - Compression Fitting \varnothing 12MM SST
 IX2B - Compression Fitting \varnothing 1/8" Brass
 IX4B - Compression Fitting \varnothing 1/4" Brass

IX6B - Compression Fitting \varnothing 3/8" Brass
 IX8B - Compression Fitting \varnothing 1/2" Brass
 IX2S - Compression Fitting \varnothing 1/8" SST
 IX4S - Compression Fitting \varnothing 1/4" SST
 IX6S - Compression Fitting \varnothing 3/8" SST
 IX8S - Compression Fitting \varnothing 1/2" SST

ORDER CODE:

Example for a Valve | PUR Linie | Brass Chrome Plated | Low Flow | Diaphragm Shut-off Valve | Manual Actuation | 2-Port Version

VPL	DS	M	AR	GX	N14F (1/4" NPT female)	0000	N14F (1/4" NPT female)	0000
	Type	Actuation	Porting Code	Working Pressure (bar)	Connection Port 1	Connection Port 3	Connection Port 5	Connection Port 7
	DS Diaphragm Shut-off Valve	M Manual	AR 2-Port (1 In 5 Out)	F1 130 *	possible connection see technical drawing	0000 without	possible connection	0000 without
				GX 300 **			see technical drawing	

* only brass fittings

** only stainless steel fittings

Order code (as described above) without special characters or spaces! Complete Order Code **VPLDSMARGXN14F0000N14F0000**



Link to online product configurator